

301 N. Hillcrest
Sulphur Springs, TX 75482

2000 I-30 E
Greenville, TX 75402

108 W. Marble
Wylie, TX 75098

Monday, June 8, 2020

Office of Hopkins County Judge
PO Box 288
Sulphur Springs TX 75483

Farmers Electric Cooperative Member: S & R CONSTRUCTION
Service Order Number: 2020053326

Greetings:

Farmers Electric Cooperative, Inc. is requesting permission to construct electrical power distribution facilities which will cross County Road 2322 which is located North of Spring Creek Cir at Pole#063007 in Hopkins County, Texas.

Site location map and construction sketches are enclosed. The construction sketch details the proposed work. All road crossings will have a minimum vertical clearance of 22 feet.

If you have any questions, please contact me at any time.

Sincerely,

Tamara Williams

Project Coordinator
twilliams@farmerselectric.coop
Phone 903-513-2903

Submitted by Psalm Harper
pharper@farmerselectric.coop
Field Engineering Coordinator

Enclosures

County Approval Section:

Approved:  Denied: _____

Authorized Signature: 

Date: 6-10-20

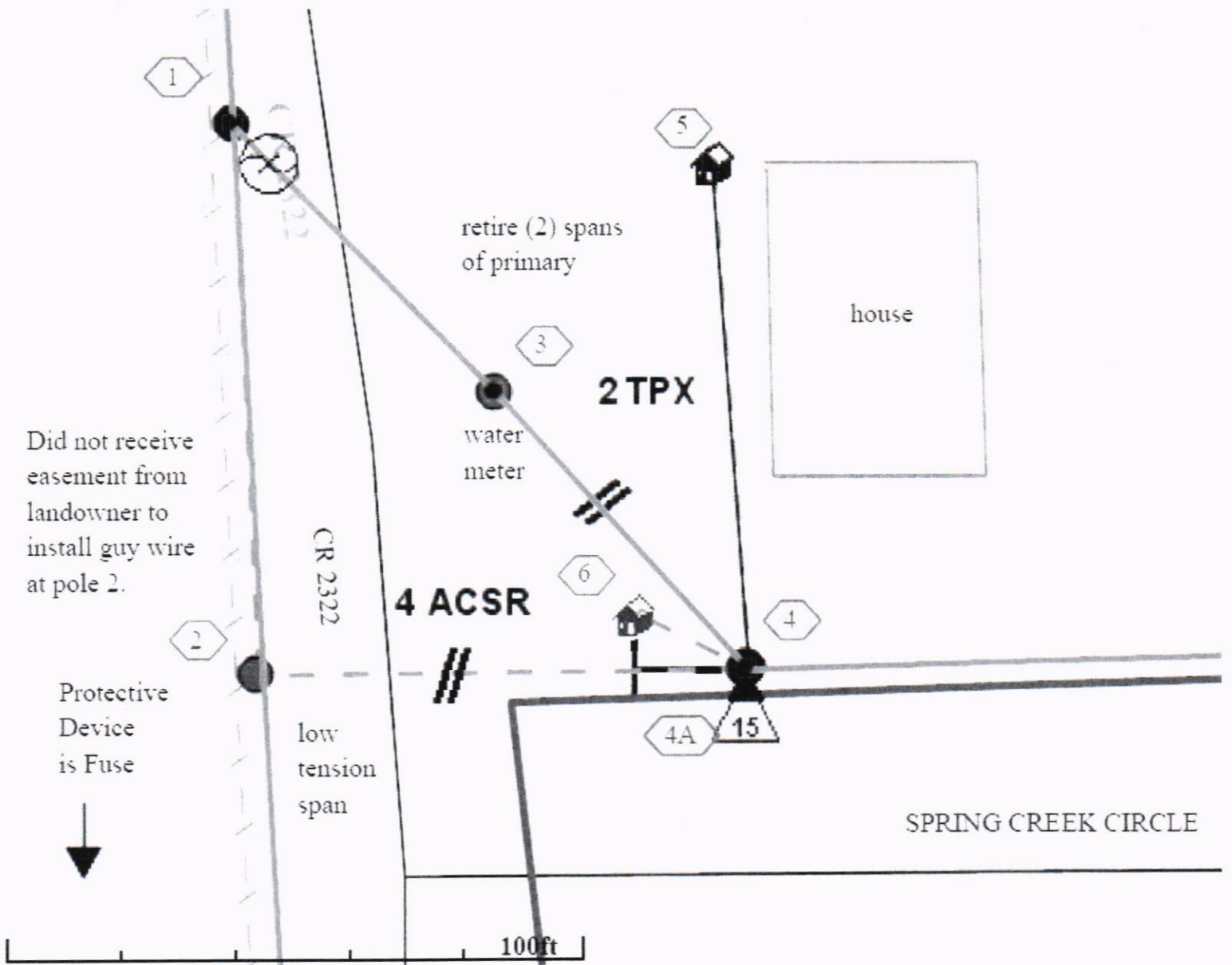

23450690052

Crossing at Pole 063007 which is N of
Spring Creek Cir

HOPKINS

H EAST SERVICE AREA
H EAST SERVICE AREA

8

SULPHUR SPRINGS ISD



S & R CONSTRUCTION

75482

063005

MARTIN ALLAIN

192089

23450690062

063008

County Road 2322

Spring C